



SEA - BIRD ELECTRONICS, INC.

1808 136th Place N.E., Bellevue, Washington 98005 USA

Telephone: (425) 643-9866 Telex: 292915 SBEI UR

Fax: (425) 643-9954

email: seabird@seabird.com

SBE P/N 50067

DATE	SYM	REVISION RECORD	AUTH	DR	CHK

SBE25 Cage Li-Cor 193SA Mount Kit

Kit Contents

SBE P/N	Manufacturer P/N	Primary SBE Application	QTY
23311	SBE 25 Li-Cor Mount	Main Sensor Mount block (3 pieces)	1
30158	Mach screw 8-32 x 5/8 PH SS	Tighten Li-Cor Mount to Li-Cor Sensor	2
30163	Mach screw 8-32 x 1 PH SS	Assembly screws for Li-Cor mount	2
30182	Mach screw 10-24 x 1-1/4 PH SS	Attach 23311 to cage	1
30249	Washer, #10 flat	For Hardware 30182	2
30254	Washer, 1/4 split ring	For Hardware 30423	1
30361	Nut, 10-24 nylon stop	For Hardware 30182	1
30423	Bolt, 1/4-20 x 1-1/2 Socket	Attach 23311 to cage, goes into SBE 25 mount block	1
30570	Washer, 1/4" flat	For Hardware 30423	1
67005	SBE Assembly Drawing	SBE 25 Li-Cor Mount Kit Assembly Drawing	1

Procedure for Kit Assembly

Drawing number 67005

A. Assembly of the mount block

1. Set sensor into place between the 2 parts of 23311 and secure to mount plate with 8-32 hardware (30158).
2. Secure mount plate to cage by removing 30423 screw from cage, and re-installing it with the washers (30254, 30570) as shown. Install 30182 Hardware with 2 washers and 30361 nut.

REFER TO ASSEMBLY DRAWING 67005 FOR INSTALLATION GUIDELINES.

Parent Part Number:

SBE Drawings:

67005 SBE35 to Li-Cor Assembly

Related Assembly:

Drawings:

Sea-Bird Electronics Procedure

PROCEDURE NUMBER: **67005.1**

TITLE: **SBE PN 50067, SBE25 to Li-Cor Mount Kit**

REVISION:

EFFECTIVE DATE: **03/20/2001**

CHECKED BY:

PAGE 1 of 1

DATE	SYM	REVISION RECORD	AUTH.	DR.	CK.

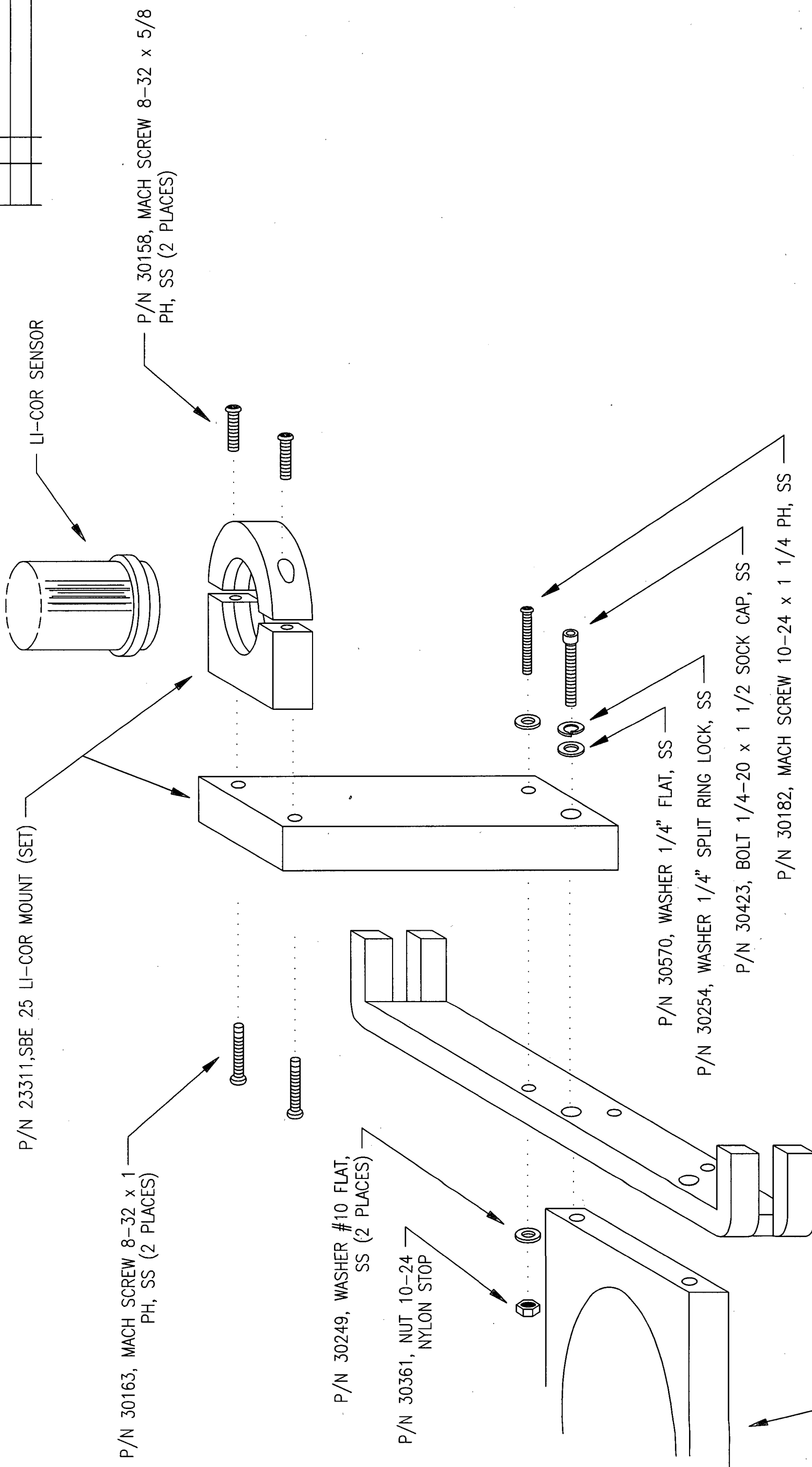

TOLERANCES		SEA-BIRD ELECTRONICS, INC	
FRACTIONAL	P/N 50067	SCALE NTS	DRAWN BY CEG
DECIMAL			APPROVED BY
ANGULAR			TITLE SBE 25 LI-COR MOUNT KIT ASSEMBLY DRAWING
	DATE 5.7.98	DWG NO.	REV
		67005	